



FINISH	White
DIMENSIONS	Basic Unit 230mm x 230mm x 260mm Double Unit 400mm x h21mm
WATTAGE	7w
LAMP	E27 LED
LUMENS	400lm
DIMMING	Mains Dim
VOLTAGE	240v
WEIGHT	1.3Kg
IP RATING	IP20

MOLECULAR_LIGHT ML_1 basic unit

PRODUKTBESCHREIBUNG:
PRODUCT SPECIFICATION:

ML_1 basic unit Art. Nr. 1025-11-0101

MATERIAL: Kugeln / Shades: PE, Beschläge / Fittings: Aluminium

FARBE / COLOUR: Weiß, silber / White, silver
LAMPE / LAMP: E27 LED, 7W, 400lm, dimm. E27 Halogen, max. 28W E27 ESL, max. 11W

GEWICHT / WEIGHT: 1,3kg / basic unit
PACKING DIMENSION: 31 x 31 x 29cm / basic unit
SONSTIGES / OTHER: Leuchtmittelwechsel durch Abziehen der einzelnen Kugeln. / To change lamps turn off shades.

TECHNISCHE ANGABEN:
TECHNICAL SPECIFICATIONS:

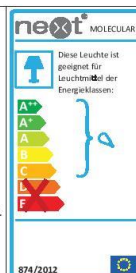

GRÖSSEN / DIMENSIONS (CM):
EINZELNES ELEMENT / SINGLE UNIT:

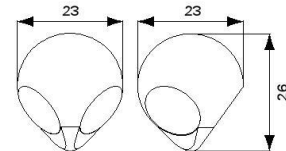

MÖGLICHE KONFIGURATIONEN / POSSIBLE CONFIGURATIONS:

